

FOR LEASE

RE/MAX
COMMERCIAL®

987 SF Retail Space in Aspen Plaza

550 - 3850 Sherwood Dr, Sherwood Park | Alberta



PROPERTY

\$ \$33.00/SF

- High profile location with immediate possession
- Large windows for great natural lighting
- Signage opportunities available; building & pylon
- Ideal for take-out restaurant or personal service shop
- Located close to high traffic daycare and next to Jugo Juice

Julie Egert
Associate
780 975 1036
julie@rcedm.ca

RE/MAX Commercial Capital
Ritchie Mill Business Center
#300, 10171 Saskatchewan Drive
Edmonton, AB T6E 4R5
780 757 1010

PROPERTY DETAILS

Address	550 - 3850 Sherwood Drive, Sherwood Park T8H 0Z9
Legal Description	1722464 Lot 64
Building Size	987 SF
Zoning	C1 Community Commercial
Tenant Improvements	Negotiable
Available	Immediately

FINANCIALS

Lease Rate	\$33.00/SF
Op Costs	\$5.25/SF
Property Taxes	\$4,400/year (2018)
Monthly Rate	\$3,500 (approx rent)

Sherwood Park



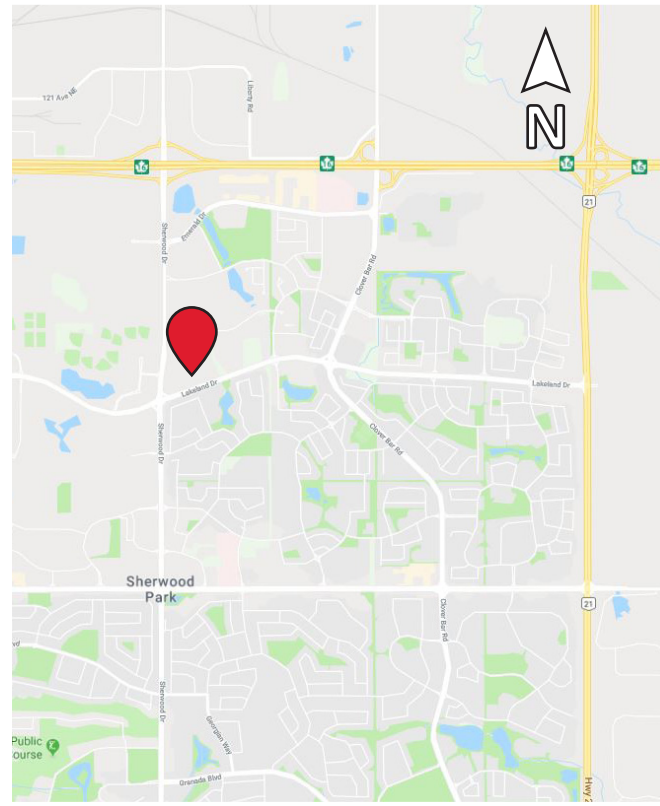

CONTACT US

Julie Egert
Associate
780 975 1036
julie@rcedm.ca



RE/MAX Commercial Capital
Ritchie Mill Business Center
#300 10171 Saskatchewan Drive
Edmonton, AB T6E 4R5
780 757 1010